



**KOLIBRI 360 Professional
Wireless Sound System**

INSTRUCTION MANUAL

Read these instructions carefully before using this product and make sure you are familiarised with safety instructions and warnings! Keep the manual for future reference!



INDEX

INDEX	2
SAFETY INSTRUCTIONS AND WARNINGS	4
⇒ POWER SOURCE/CHARGER	4
⇒ WATER WARNING	5
⇒ PLACE OF USE	5
⇒ CONNECTION	6
⇒ MAINTENANCE, CARE AND STORAGE	6
⇒ OPENING THE DEVICE AND CHANGE	6
⇒ IN CASE OF ABNORMALITY	6
⇒ OTHER WARNING AND PRECAUTION	6
⇒ DISPOSAL INSTRUCTIONS	7
⇒ BATTERY REPLACEMENT	8
ABOUT THE KOLIBRI SYSTEM	9
⇒ MAIN FUNCTIONS	9
⇒ KOLIBRI SYSTEM CONTENT	10
DISPLAY AND FUNCTION	11
⇒ CONTROL PANEL	11
⇒ LED MEANING	11
→ Speaker LED display	11
→ Charger LED display	12
SET-UP	12
⇒ SELECTION OF A SUITABLE PLACE	12
⇒ INSTRUCTIONS FOR SETTING UP A STAND	14
⇒ INSTRUCTIONS TO SET-UP THE SPEAKER	15

OPERATING INSTRUCTION	16
⇒ BEFORE YOU USE THE KOLIBRI SYSTEM	16
⇒ USE OF THE KOLIBRI SYSTEM	16
⇒ CHARGING THE KOLIBRI SYSTEM	17
⇒ CHARGE OF THE KOLIBRI SYSTEM DURING ITS USE	17
⇒ CONNECTION TO A BLUETOOTH DEVICE	18
⇒ CABLE CONNECTION OF EXTERNAL DEVICES	18
⇒ USE OF SENNHEISER WIRELESS MICROPHONE	19
→ Presentation of the SKM 100-835 G3 hand-held microphone	19
→ Presentation of the SKM 100-835 G3 hand-held microphone display panel and SK 100 G3 receiver	19
→ Presentation of the Transmitter SK 100 G3	20
→ Battery replacement	20
→ Use of the SKM 100-835 G3 hand-held microphone	21
→ Use of the microphone with SK 100 G3 transmitter	23
⇒ RECOMMENDATIONS WHEN USING WIRELESS MICROPHONE	24
TROUBLESHOOTING	25
TECHNICAL DATA	27
⇒ KOLIBRI 360 SOUND SYSTEM	27
⇒ WIRELESS TRANSMITTER SKM 100-835 G3	27
⇒ POCKET WIRELESS TRANSMITTER SK 100 G3	28
⇒ MANUFACTURER, SELLER AND AUTHORISED SERVICING CENTRE	28
WARRANTY STATEMENT	29
⇒ WARRANTY CERTIFICATE	31

SAFETY INSTRUCTIONS AND WARNINGS



Read these instructions carefully before using the Kolibri system and make sure you are familiarised with safety instructions and warnings indicated below. Kolibri system should always be used in accordance with these instructions. Warranty does not cover damage caused to the product due to failure to comply with these instructions or misuse. We will also assume no responsibility for intentional damage to the product or damage incurred to any property due to misuse of the product.

Warnings provided below are aimed at informing you on the safe and proper operation of the Kolibri system and its accessories, preventing malfunctions of the Kolibri system and injuries to all people involved. Below are some of the warnings that must be strictly followed when using the system.

→ POWER SOURCE/CHARGER

- Only use the Kolibri system charger. Use of unsuitable charger may cause fire, electric shock, overheating or improper charging and damage to the Kolibri system.
- Do not expose the charger to rain, humidity or dust.
- Always use the voltage specified in the instruction manual and the information included in the housing of the system.
- Never touch the plug or power supply cable with wet hands to avoid electric shock. When disconnecting from the mains do not pull the cable by the flexible part, but only the plug. This is the only way you can avoid causing a short-circuit and/or electric shock.
- Never bend, modify or otherwise damage the power cord and place it near heat sources, place heavy objects on it or place it where anyone could walk on, trip over or place anything over it. Such handling may cause short-circuit, fire or electric shock and may cause injuries to people in the vicinity. Cut or damaged power supply cable should be immediately replaced.
- Disconnect the charger from the outlet during storms.
- Do not connect the Kolibri system into electrical outlet via an electric distributor. This

may cause overheating and poorer sound quality.

→ WATER WARNING

- Do not expose the product to rain, damp and wet spaces, or place on it any containers with liquid that might spill into the openings. If any liquid enters inside the device, immediately turn off the device and unplug the power supply cable from the outlet.
- In case of an outdoor use of the product, i.e. in the rain, you must protect it with a PVC cover that must cover the entire system to prevent liquid penetration. Kolibri system is not waterproof!

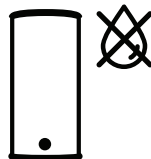

→ PLACE OF USE

- Do not expose the product to excessive dust or vibrations or extreme cold or heat (do not leave the product in direct sunlight, near heaters, or in a car during the day) to prevent panel disfiguration or damage its internal components.
- Do not use the product near a TV, radio, stereo equipment, mobile phones or other electric devices that might generate noise.
- Do not place the product on unstable and/or uneven surface where it could fall over.
- Do not use the product when there are strong winds, as it may fall over and cause damage to the components and injuries to the people standing close to the product.
- Before moving the product, remove all connected power and other cables.
- Before setting up the product, make sure that an outlet, which you might use, is easily accessible. In case of any problems or malfunctions, immediately turn off the device and disconnect the plug from the outlet. Even if the device is turned off, electricity is still flowing to the device at the minimum level. When you are not using the product for longer period of time, unplug the power supply cable from the wall outlet.
- Use only the stand designated for this device. Only use the provided screws to mount the stand. Otherwise, you may cause damage to the components of the device and/or tip it over.

→ CONNECTION

- Before turning the power on or off for all components, set all volume levels to minimum. Be sure to set the volume of all components to their minimum levels and then gradually raise it until you reach the desired level.

→ MAINTENANCE, CARE AND STORAGE

- Use a soft, dry cloth to remove dust and other impurities from the product.
- Do not use alcohol, benzene or other flammable liquids and aggressive cleaning agents.
- Store the product and its accessories in a **dry place** at **room temperature** and inside its enclosed packaging (case).
- **We recommend you store the case in horizontal position, following the instruction sign "Kolibri" upwards!**

→ OPENING THE DEVICE AND CHANGE

- Any change or alteration to the Kolibri system is prohibited for safety and licence reasons.
- Do not open the Kolibri system or attempt to disassemble or change it any way. If it shows malfunctioning, discontinue its use immediately and send the Kolibri system to an authorised service centre.

→ IN CASE OF ABNORMALITY

Consult an authorised servicing centre:

- If you notice that the power cord or plug is frayed or damaged. You should stop using the power cord and replace it with a new one.
- If there is a sudden loss of sound during use.
- If you notice smoke or detect an unusual odour. In this case, immediately stop using the system, turn it off and unplug the power cord as well as any other cables.
- If the system is exposed to excessive wetting, water, mechanical damage, such as falls, etc.
- If you determine safe use is no longer provided.

→ OTHER WARNING AND PRECAUTION

- The Kolibri system is not a toy and you should therefore never allow children to play with the system or stay in its vicinity unattended.
- All people involved in the operation, installation and service of the device, must be appropriately qualified and comply with the instruction manual.
- You should never leave the packaging unattended as it can pose a threat to children!

- Do not touch any gap with your finger or hands.
- Never insert paper, metallic or any other objects into the gap in the control panel. If this occurs, immediately turn off the device and unplug the power cord from the outlet.
- Do not place any weight over it or heavy objects on the device. Do not apply excessive force on the buttons, switches or connectors.
- Do not use the device at high or unpleasant volume for too long, as this might cause a permanent hearing loss. Seek medical help in case of hearing loss or ringing in the ears.
- If you are not sure whether the connection is correct or if any issues not covered in this instruction manual occur, do not hesitate to contact the support or an expert of your choosing. Consult an expert in case of any doubts regarding its operation or safety.

→ DISPOSAL INSTRUCTIONS



This device should not be disposed as household waste after the end of its service life!

Electronic devices should be disposed in accordance with the Waste Electrical and Electronic Equipment (WEEE) Directive and be taken to local collection point for waste electronic equipment!



Symbol of crossed-out wheeled bin means that waste devices and batteries should not be disposed of with normal household waste as they contain substances dangerous to the environment and harmful to human health. After the end of the service life of the device and the battery, take it to a collection point at a store, distributor or a public utility company collection point.

Take a step towards green and visit website www.ozavescen.si where you will find detailed information on recycling waste appliances, devices, batteries, car batteries and other waste. Website provides a list of collection points and public utility company collection points and information on reuse centres where you can take functioning devices and apparatus.



CE marking is a conformity mark used exclusively by regulatory authorities, and does not represent any warranty regarding product characteristics.

➔ BATTERY REPLACEMENT

- Batteries in the speaker have a limited number of charge cycles and eventually need to be replaced. The battery of the Kolibri system (speaker) should never be replaced by the user. They may only be replaced by an authorised servicing centre which then disposes of the batteries in accordance with local regulations and rules.
- Always make sure the AA batteries are inserted in conformity with the +/- polarity markings. Failure to do so might result in overheating, fire or battery fluid leakage.
- Always replace all batteries at the same time. Do not use new batteries together with old ones. Do not mix battery types, such as alkaline batteries with manganese batteries, or batteries from different manufacturers or different types of batteries from the same manufacturer, as this can cause overheating, fire, or battery fluid leakage.
- Do not place used batteries in a fire.
- Do not attempt to recharge non-rechargeable batteries. This could cause an explosion.
- Keep the batteries out of reach of children.
- In case of battery liquid leakage, avoid any contact with the liquid. If the liquid comes into contact with the eyes, mouth or skin, immediately rinse with water and seek medical help. Battery liquid is corrosive and may cause loss of vision or chemical burns.
- Used batteries should not be disposed as household waste! You should dispose them at a collection point intended for used batteries.



ABOUT THE KOLIBRI SYSTEM

→ MAIN FUNCTIONS

Thank you for purchasing Kolibri PA sound system.

Kolibri is a portable public address sound system, a result of expertise and desire to provide a user-friendly product. It is distinguished by ease of use, high-end technology and compatibility with other devices. Kolibri system provides a quality sound system for all kinds of events, ceremonies and presentations, reaching up to 500 listeners* and also not easily accessible locations as the battery guarantees 8 hours of autonomy**.

Main features of the Kolibri system:

- **Exceptional form for a quality 360° sound** – 12 speakers provide for the acoustic basis arranged in a compact, cylindrical sound system that achieves the same level of sound and sound quality for each of the listeners.
- **Take less than one minute to set-up the speaker** – simple components enable you to set up the Kolibri system in less than one minute.
- **Easy and light to carry** – Kolibri is made of aluminium and other quality materials, weighting only 5.5 kg***. Enclosed case provides for an elegant and easy carrying.
- **Easy to use and maintain** – the system is completely automated and easy to use.
- **Battery powered** – the system can operate for 8 hours without electric supply.
- **Sennheiser wireless microphone** – you can use the speaker without cables, as the system has an in-built wireless receiver, hand-held, clip-on or headset Sennheiser wireless microphone (depends on the chosen package).
- **Compatible with other devices** – Using the built-in Bluetooth interface, you can connect Kolibri wirelessly to any computer, telephone and other Bluetooth devices. You can play music and use the microphone at the same time.

* Data applies to optimal conditions and correct setting up of the system. Additional Kolibri systems allow you to use the sound system for even larger audience.

** Battery life depends on usage and configuration.

*** Weight of approximately 5.5 kg applies to Kolibri system with one in-built Sennheiser receiver.

- **Versatility** – Indispensable at all types of events (seminars, conferences, shows, weddings, etc.) as a PA sound system or for playing music in the background while reaching up to 500 listeners*.
- **For all weather conditions** – Special PVC cover protects the system against rain without affecting sound quality.

→ KOLIBRI SYSTEM CONTENT



BASIC package contains:

- Kolibri sound system with in-built Sennheiser receiver
- Stand for Kolibri system
- Hand-held Sennheiser microphone
- Sennheiser microphone mount for a stand
- Kolibri system charger
- 4 AA batteries
- PVC covers for the speaker (30 single-use pieces)
- Auxiliary input cable
- Case

PREMIUM package is a basic package with:

- Sennheiser transmitter with Sennheiser headset and clip-on microphone



* Data applies to optimal conditions and correct setting up of the system. Additional Kolibri systems allow you to use the sound system for even larger audience.

DISPLAY AND FUNCTION

→ CONTROL PANEL

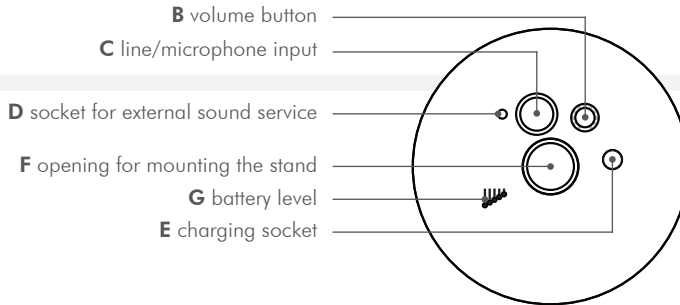

→ LED MEANING

Speaker LED display



When **ALL** LED diodes are lit, they indicate fully charged, i.e. 100 % charge.



Red and orange LEDs indicate 40% charge.



Red, orange, yellow and green LEDs indicate 80 % charge.



Red LED indicates 20% charge.



Red, orange and yellow LEDs indicate 60% charge



Flashing orange LED on ON button (A) indicates less than 40% charge.

Charger LED display

Red LED indicates the speaker's battery is charging.

Green LED indicates a fully charged battery. Charging is then stopped.

SET-UP

→ SELECTION OF A SUITABLE PLACE

- **Where and when the Kolibri system should not be set-up:**

Do not use the product near a TV, radio, stereo equipment, mobile phones or other electric devices that might generate noise.

Do not place the product on unstable and/or uneven surface where it could fall over!

Do not expose the product to strong winds, as it may fall over and cause damage to the components and injuries to people standing close to it.

- **Choosing a suitable setting up place**

Proper set-up depends on more factors, such as the number of listeners, position of listeners, size of the room and accessibility of an electric outlet when you want to connect the speaker to the mains (location of an outlet should be checked first).

If the space allows it, the system can be set-up among the audience, but only if the speaker can be placed at least 2 meters in front of the audience and the speaker.

Image: Example of speaker set-up

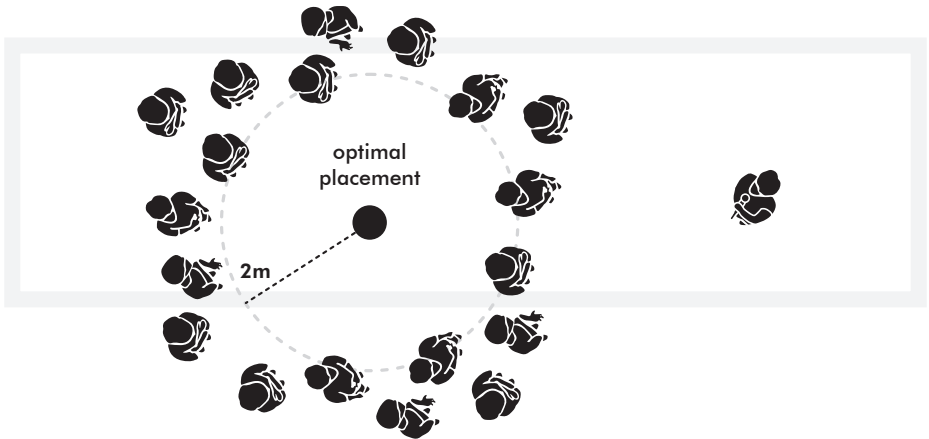
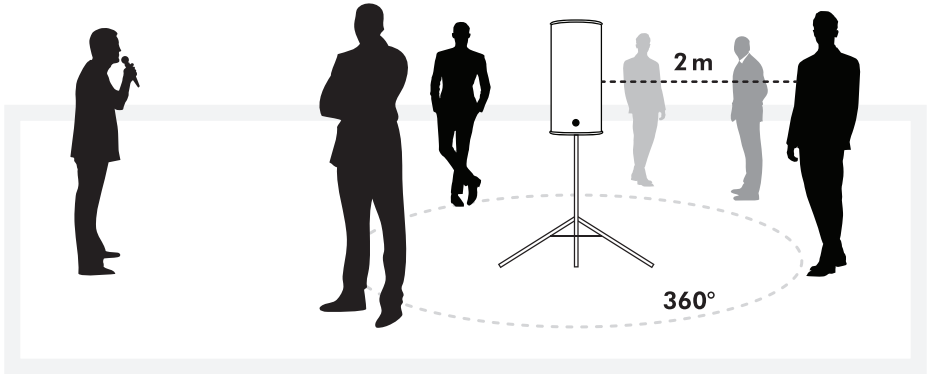

→ INSTRUCTIONS FOR SETTING UP A STAND

! Safety instructions

- To ensure maximum safety, the legs of the stand must be completely expanded.
- Connecting crossbars of the stand's legs must be in a horizontal position.
- The stand can only be placed on even and stable surfaces!
- **CAUTION! In case of strong winds, the speaker must be lowered to the lowest point on the stand or not used at all. Strong winds might cause the stand with mounted speaker to fall over.**

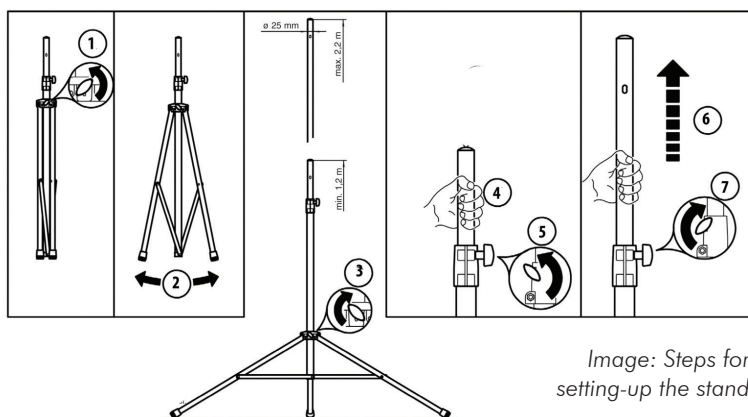

1. Unscrew the screw located at the foot of the stand.
2. Pull out the legs of the stand until connecting crossbars are in a horizontal position.
3. Tightly screw on the screw located on the foot of the stand.
4. Hold the extension pole of the stand with one hand.
5. Unscrew the height adjustment screw and make sure not to unscrew it completely.
6. Mount the speaker on the stand.
7. Set the extension pole to the desired height.
8. Tighten the stand height adjustment screw.

Dismantle the stand in the reverse order.

→ INSTRUCTIONS TO SET-UP THE SPEAKER



CAUTION! Make sure you are holding the speaker with both hands when mounting it on the stand.

1. Carefully take the speaker device out of the case, holding it firmly with both hands. This way you can mount the speaker safely.
2. Carefully mount the speaker device on the stand. **Make sure not to damage the lower part of the speaker device when inserting the stand into its opening!**
3. Turn the front side of the speaker device (side where power ON button is located) towards the person operating it. This provides the operator a good control over the operation of the speaker device.

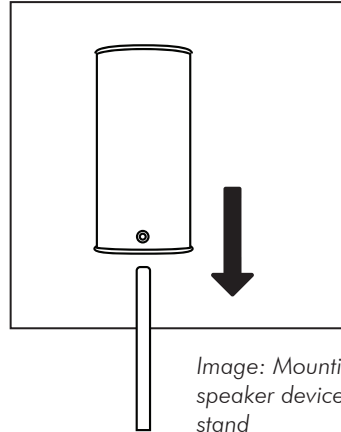

Image: Mounting the speaker device on the stand

OPERATING INSTRUCTION

→ BEFORE YOU USE THE KOLIBRI SYSTEM



Prior to each use, check whether the speaker's batteries are charged. To do that, turn on the Kolibri system, and if all green LEDs are lit, the battery is fully charged. If only red LEDs are lit, we recommend you charge the speaker device. Completely dead batteries need approximately 8 hours of charging to be charged completely.

If you are using the wireless microphone, it is strongly advisable to check the battery status. You can check the battery status by turning on the microphone and checking the battery status on the display panel. The same applies to the clip-on or headset microphone. It is always advisable to have at least two spare batteries (type AA, 1.5 V).

→ USE OF THE KOLIBRI SYSTEM

1. First, find a suitable place to set up the speaker.
2. Place the case in a lying position considering the Kolibri inscription upwards, open both clasps and lift the cover.
3. Mount the speaker on the stand.
4. Set the volume button (B) to 5.
5. Use Power ON button (A) to turn on the speaker device. You can do that by pressing and holding the button (A) for 2 seconds. An orange LED encircling the button lights up. A flashing orange LED indicates the battery is charged at less than 40%.
6. Turn on the wireless microphone (see chapter: Using wireless microphone) or connect a wired microphone (outlet C, MIC/LINE input) or an external sound source (AUX-D outlet).
7. Set the volume of the speaker on the control panel (button B) and make sure not to cause microphonics! (Suggestion: when indoor, set the volume at VOLUME 5, and at VOLUME 8 when outdoor).

8. Then adjust the volume of external devices (telephone, iPod and other), until you reach the ideal volume.
9. When you finish using the Kolibri system, first turn off the microphone or other connected devices.
10. Then turn off the speaker device by pressing and holding button (A) until the light goes off.
11. Clear all accessories and put them in the case.
12. Fold the stand, put the speaker device in the case and store it in a **dry place at room temperature, in a lying position and considering the Kolibri inscription upwards.**

→ CHARGING THE KOLIBRI SYSTEM

1. Make sure the Kolibri system is turned off (LED on the Power ON button and LED indicator are not lit).
2. Plug the charger into electrical outlet (220 V).
3. Only then plug the cable in the outlet for charging the Kolibri speaker (E).

Charging: red LED on the charger indicates charging.

Charging complete: the battery is completely charged when the **green LED** on the charger is **lit**.



Unplug the charger from the outlet whenever you are not using it or during storms.

→ CHARGE OF THE KOLIBRI SYSTEM DURING ITS USE

You can use the charger while using the speaker.



If red LED (G) is lit during speaker operation, it is strongly advisable to connect it to the charger as soon as possible! In this way, you can use the speaker device and charge the battery at the same time.

→ CONNECTION TO A BLUETOOTH DEVICE

In order to use Bluetooth transfer, you need a Bluetooth device (mobile phone, laptop, MP3 player, etc.) which can stream Bluetooth stereo signal and is compliant with the Bluetooth Advanced Audio Distribution profile (A2DP). Kolibri 360 enables Bluetooth version 3.0.

Connection procedure

1. Turn on the Kolibri 360.
2. On your Bluetooth device, go to Bluetooth menu and activate the search. Name Kolibri 360 appears in search results.
3. By clicking on Kolibri 360, you will be prompted to enter a password, which is identical to the Kolibri 360 serial number on the control panel.
4. The device confirms the connection.



Connecting a Bluetooth device must be performed each time the sound system is turned on.



WARNING! If your Bluetooth device is a mobile phone, we strongly advise you to set the phone in the so-called flight mode. This way, you can prevent the disconnection in case of a phone call.

→ CABLE CONNECTION OF EXTERNAL DEVICES

If you would like to connect an external sound source (e.g. MP3 player, mixing desk) using a cable, use the cable for an external sound source.

Plug the cable in the outlet (C) and connect the MP3 player or other device. Observe volume settings of the speaker and connected external device. Follow the manufacturer's instructions for proper operation of the connected device.

→ USE OF SENNHEISER WIRELESS MICROPHONE

Presentation of the SKM 100-835 G3 hand-held microphone

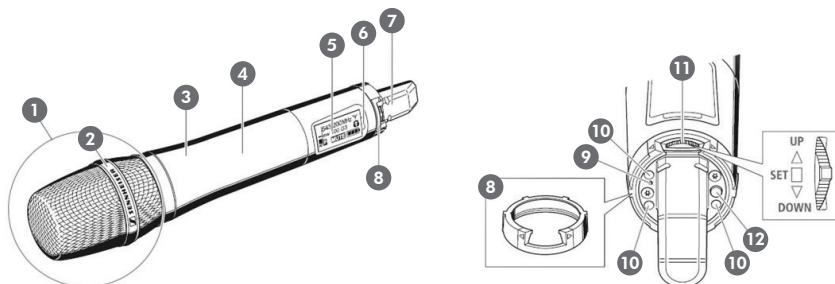

1. Microphone head
2. Microphone diaphragm
3. Microphone holder
4. Battery compartment
5. Display panel (backlit in orange)
6. Infra-red interface
7. Antenna
8. Protection ring
9. Operation and battery status indicator, red LED (lit = ON, flashing = low battery)
10. Charging contacts
11. Multi-functional switch (Up = upward movement, Down = downward movement, Set = confirm setting)
12. ON/OFF button, serving also as an ESC/CANCEL key in the menu

Presentation of the SKM 100-835 G3 hand-held microphone display panel and SK 100 G3 receiver

1. Audio level "AF"
2. Current transmission frequency
3. Name (option for a user selectable name)
4. RF signal transmission icon
5. Activated lock mode
6. Pilot tone "P"
7. »MUTE« (audio signal is muted)
8. Battery status: 100 % charge, 70 % charge, 30 % charge, charge status is critical – the red LED (LOW BATTERY) is flashing!

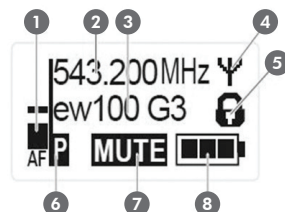

Presentation of the Transmitter SK 100 G3

1. Microphone input (MIC/LINE), 3.5 mm jack socket
2. MUTE switch
3. Antenna
4. Operation and battery status indicator, red LED (transmitter on), flashing red LED (low battery)
5. Audio over modulation indicator yellow LED (AF PEAK)
6. Charging contacts
7. Settings button (SET)
8. Rocker button (up/down)
9. Battery compartment
10. Battery compartment cover
11. Battery compartment catches
12. Infra-red interface
13. ON/OFF button, serving also as an ESC/CANCEL key in the menu
14. Display panel (backlit in orange)

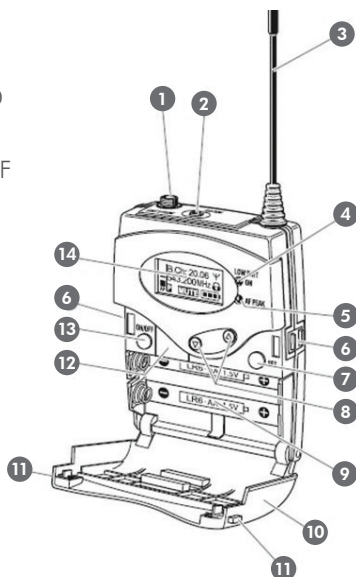

Battery replacement

Only use 1.5 V AA batteries for the hand-held microphone or clip-on/headset microphone transmitter!

To insert batteries in the hand-held microphone, unscrew the lower part of the microphone by turning it counter-clockwise (3). Slide downwards the lower part of the microphone as far as it goes. Open the battery compartment cover (13) and insert the batteries while observing the correct polarity! Close the battery compartment cover and push the battery compartment cover upwards, screwing it onto the microphone's body.

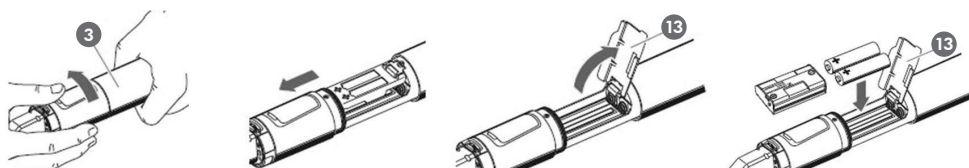

When unscrewing the lower part of the hand-held microphone during operation, the muting function is automatically activated ("MUTE" appears on the display panel). When you close the lower part of the microphone, muting is automatically cancelled.

In SK 100 G3 transmitter, the batteries are replaced by simultaneously pressing on both catches of the battery compartment cover (11) and open the cover (push upwards). Observe correct polarity when inserting the batteries! Close the cover by pressing it in the middle (10) until it locks into place.

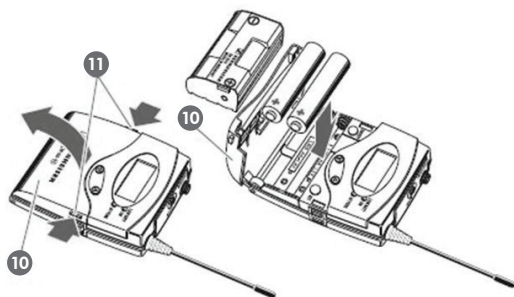

Use of the SKM 100-835 G3 hand-held microphone

1. **!** *Always hold the hand-held microphone at the centre of the handle, and not at the lower part where the antenna is located (7)! Holding the microphone by the antenna might cause sound disturbances! Hold the microphone as close to your mouth as possible.*



2. Switching the microphone ON/OFF:

To **switch the microphone on**, press the ON/OFF button (12). The microphone begins to transmit an RF signal, the transmission icon (4) is displayed, and the red LED lights up (9). Name and frequency of the microphone appear on the display panel.

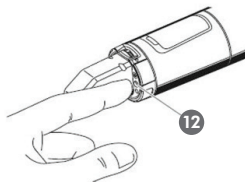

To **switch the microphone off**, press and hold the ON/OFF button (12) until "OFF" appears on the display panel. The red LED (9) goes off and the display panel turns off.



3. If the microphone is switched on but it does not connect to the Kolibri system, it is possible the microphone has been set at a wrong frequency or the RF signal transmission is locked.

! *The microphone and the in-built receiver in the Kolibri system must be always set at the same frequency. Check the frequency stated in the warranty certificate and adjust the microphone's frequency, if needed.*



CAUTION! *In case you are using two wireless microphones, make sure they are set at different frequencies, but in accordance with the in-built receivers. Setting both microphones at the same frequencies will cause sound disturbances!*

To **reset the frequency**, call up the "Frequency preset" menu in the menu bar by means of a multi-function switch (11). Confirm the menu (Image 1). Choose the correct frequency and confirm the selection (Image 2). Then, select the frequency channel (Image 3) and confirm or store the setting. "Stored" appears on the display panel, indicating the reset settings have been successfully stored.



Activating and deactivating the RF signal

To **deactivate the RF signal**, press the ON/OFF button. The following appears on the display panel: "RF Mute Off?". Then press the multi-function switch so the "RF Mute On?" is displayed. Confirm. The transmission icon (4) is no longer displayed.

To **activate the RF signal**, press the ON/OFF button until "RF Mute On" appears on the display panel. Then, press the multi-function switch so "RF Mute Off?" is displayed. Confirm. Transmission icon (4) appears on the display panel.



Use of the microphone with SK 100 G3 transmitter

1. SK 100 GR transmitter can be used with a microphone (headset, clip-on). To connect the microphone and transmitter, connect the microphone's 3.5 mm jack plug (15) to the transmitter's jack socket MIC/LINE (1). Lock the jack plug by screwing down the coupling ring (16).

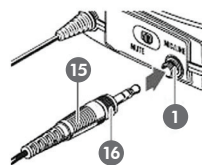

2. Switching the transmitter ON/OFF:

To switch on the transmitter, simultaneously press on both catches of the battery compartment cover (11) and open the cover. Press the ON/OFF button (13). The transmitter begins to transmit an RF signal, the red LED lights up (4) and name and frequency of the transmitter appear on the display panel. RF transmission icon (4) is displayed.

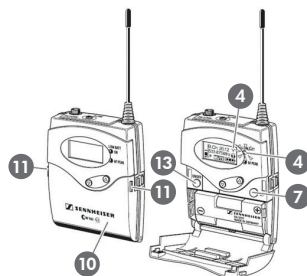

To switch the transmitter off, press and hold the ON/OFF button until "OFF" appears on the display panel. The red LED and display panel turn off.

3. If transmitter is switched on but it does not connect with the Kolibri system, it is possible the transmitter is set at a wrong frequency or RF signal transmission is locked. Reset the transmitter to a correct frequency and check the RF signal transmission.

To **deactivate the RF signal**, press the ON/OFF button until "RF Mute Off" appears on the display panel. Then press the rocker button so the "RF Mute On?" is displayed. Confirm with the SET button (7). The transmission icon (4) is no longer displayed.

To **activate the RF signal**, press the ON/OFF button until "RF Mute On" appears on the display panel. Then press the rocker button so "RF Mute Off?" is displayed. Confirm using the SET button (7). Transmission icon (4) appears on the display panel.

→ RECOMMENDATIONS WHEN USING WIRELESS MICROPHONE



CAUTION! Do not expose the microphone to moisture and prevent penetration of water and other liquids



The Kolibri system and transmitter (hand-held, clip-on or headset microphone) should not be apart for more than 50 m when using them outdoor. Otherwise, the RF signal may be interrupted. You are strongly advised to walk through the entire venue and check RF signal overage before the event.

Wireless transmission is done by a transmission path that is not exclusive, thereby potential disturbances cannot be excluded. Disturbances can also be caused by switching procedures, electric motors, or faulty electric devices. Range within buildings can differ greatly from the outdoor range. Along with transmit power and receiver characteristics, environmental impacts, such as air humidity and building characteristics, are also important factors.

Always hold the hand-held microphone at its centre and as close to your mouth as possible. If you want to improve the volume, draw the microphone closer to your mouth or adjust microphone sensitivity. To **reset the microphone sensitivity**, activate the “Sensitivity” menu in the menu bar in the microphone display panel by means of a multi-function switch. Confirm the menu by pressing the multi-function switch. Then scroll down the menu to select the desired sensitivity (advice: Sensitivity 6 is used when the speaker is not holding the microphone close and Sensitivity 12 is used when the person speaking is holding the microphone close). Confirm the sensitivity by pressing the multi-function switch. “Stored” appears on the display panel, indicating the settings have been successfully stored.

TROUBLESHOOTING

TROUBLE	POSSIBLE CAUSE AND SOLUTION
When you use your mobile phone, you hear a rustling sound.	Using a mobile phone near the Kolibri system can cause disturbances. In order to prevent disturbances, turn off your mobile phone when near the Kolibri system, or use it only while keeping some distance from the system.
LEDs on the Kolibri system are lit, but there is no sound.	<p>Make sure the volume button is set to a medium or maximum volume level.</p> <p>Make sure the microphone or an external sound source device is switched on.</p> <p>Check whether the device (iPod, etc.) is set at a suitable volume level.</p> <p>Make sure the external sound source device is plugged into correct outlet.</p>
The charger is connected to the Kolibri system and plugged in the mains, but neither red nor green LED are lit.	<p>Make sure you are using the original Kolibri charger.</p> <p>Check the control panel of the speaker if the charger is plugged in the correct outlet.</p> <p>Check if the charger is properly connected to the electric outlet.</p>
There is no audible sound or it seems as if the sound is cut or interrupted.	<p>Check the microphone battery status. It might be low, thereby causing sound interruptions.</p> <p>Microphone user and Kolibri system are too far apart.</p> <p>Set the Kolibri system at a place where the sound cannot be interfered by several obstacles (walls, furniture, etc.).</p> <p>Bluetooth sound source is out of range. Reduce the distance between the Bluetooth sound source or eliminate potential obstacles.</p>

TROUBLE	POSSIBLE CAUSE AND SOLUTION
<p>The microphone causes microphonics.</p>	<p>You are using the microphone too close to the Kolibri speaker.</p> <p>Increase the distance between the speaker and microphone user.</p> <p>Lower the volume on the speaker control panel.</p>
<p>There are sound disturbances when using two or more microphones.</p>	<p>Microphones are set at the same frequencies. Change the frequency of all microphones so they are different, but in accordance with the in-built receiver.</p> <p>Contact an authorised servicing centre.</p>
<p>When using mobile phone as a Bluetooth device and there is an incoming call, music playback is interrupted.</p>	<p>Set the phone in the so-called flight mode. This way, you can prevent the disconnection in case of a phone call.</p>
<p>Mobile phone does not detect the Kolibri 360 system.</p>	<p>The Kolibri 360 might not be connected to a previously paired device. Turn off the connected device or remove it from the range.</p> <p>Bluetooth disabled. Enable the Bluetooth function on your mobile phone and turn on the phone before you turn on Kolibri 360.</p>

TECHNICAL DATA

→ KOLIBRI 360 SOUND SYSTEM:

- autonomy: 8 hours*
- weight (approx.): 5.5 kg
- LED indicators: power on, battery status
- dimensions: ϕ 200 mm x 410 mm
- charger (100–240 V): 16.8 V/0.9 A
- charging time: approx. 7 hours
- volume control: yes
- microphone input: XLR-3 – symmetrical
- line input: TRS – symmetrical; 6.3 mm jack connector
- power connector: 2.5 mm DC
- amplifier: 4 x 42 W, class AB
- battery: LI-PO 4C 16.8 V
- Peak SPL: 100 dB @ 10 M
- coverage (horizontal x vertical): 360° x 20°
- built-in Sennheiser EK 100 G3 receiver with UHF diversity
- operating temperature: from -10 °C to +40 °C
- charging and storage temperature: from 0 °C to +40 °C

→ WIRELESS TRANSMITTER SKM 100-835 G3 – roční mikrofón:

- microphone type: Sennheiser, dynamic, cardioid
- sensitivity: 2.1 mV/Pa
- autonomy: approx. 8 hours
- weight: 450 g (batteries included)
- dimensions: ϕ 50 mm x 265 mm
- battery charging: 2 x 1.5 V AA batteries
- adjustable range of input sensitivity: 48 dB, in increments of 6 dB
- frequency range: 80–18,000 Hz

* Battery life depends on usage and configuration.

→ POCKET WIRELESS TRANSMITTER SK 100 G3

– with clip-on and headset microphone:

- clip-on microphone type: Sennheiser, model ME 4, polarised, condenser, cardioid
- headset microphone type: Sennheiser, model ME 3-ew, prepolarised, condenser, cardioid
- sensitivity: 40 mV/Pa (ME 4), 1.6 mV/Pa (ME 3-ew)
- autonomy: approx. 8 hours
- weight: 160 g (batteries included)
- dimensions: 82 mm x 64 mm x 24 mm
- battery charging: 2 x 1.5 V AA batteries
- adjustable range of input sensitivity: 60 dB, in increments of 3 dB
- frequency range: 25–18,000 Hz



Sennheiser microphones and in-built receivers comply with the following standards: EN 301489-1/-9, EN 300422-1/-2, EN 60065 and EN 62311 (SAR). The Kolibri system is compliant with the EN 301 489-3 standard.

We reserve the right to make technical changes to improve the product. Instruction manual is property of KOBRA Team, d. o. o., Levičnikova cesta 2, 8310 Šentjernej. Images are of purely illustrative nature. ©11/2017 V1

MANUFACTURER, SELLER AND AUTHORISED SERVICING CENTRE:

KOBRA

KOBRA Team, d. o. o.
Levičnikova cesta 2
8310 Šentjernej
Slovenia

T: +386 7 30 81 118
M: + 386 41 600 700
E-mail: info@kobra.si
Websites: www.kolibrisound.si;
www.kobra.si

WARRANTY STATEMENT

KOBRA Team, d. o. o. (manufacturer, seller) hereby declares:

- That the product will function faultlessly during the warranty period if used in accordance with enclosed instruction manual.
- That the warranty period for the device and its accessories (regardless of a package purchase or purchase of an individual product) is **12 months**, following the date of purchase and delivery of the product to the consumer. Warranty period is extended by the warranty repair period.
- That we will eliminate failures and defects within the warranty period which may not be longer than 45 days following the day the device has been delivered for repair. In case the product is not repaired within 45 days, we will replace the product with a new, faultless product. We also cover delivery costs, namely to a maximum amount of the public postal services (Pošta Slovenije).
- That we will provide for service and required spare parts for the product for at least three times the basic warranty period.
- That the warranty is valid within the territory of the Republic of Slovenia.
- That the warranty does not exclude consumer's rights arising from seller's liability to defects.
- That the warranty shall become valid from the day the product is purchased, which the buyer can demonstrate with a receipt and correctly filled out warranty certificate.

Warranty does not cover malfunctions due to the following:

- Unprofessional or negligent use, not compliant with the enclosed instruction manual.
- Unauthorised interference with the device (physical or program).
- Mechanical damage (e.g. damage caused by sharp objects, bending, pressing, falls, etc.).
- High-voltage surges, exposure to chemicals, liquids, extreme heat, or due to disasters – floods, fire, or other force majeure.
- Assembly which is not compliant with instructions for setting up the product.
- Normal wear of the product (including wear of the control panel, batteries, etc.).

- Connecting the device with improperly installed or faulty accessories.
- Use of the device for other purposes than intended.
- Exposing the battery to short-circuit, if signs of unauthorised servicing are visible or if the battery was used in equipment for which it is not intended.
- If the device has been opened, modified or repaired by any person other than an authorised servicing centre, if the device was repaired using unapproved spare parts or if the parts were removed, deleted, distorted, modified, or if serial number is unreadable.
- If data on the warranty certificate or the receipt have been changed or corrected.

Enforce of a warranty claim

In order to enforce a warranty claim, notify the authorised servicing centre on the malfunction and deliver the device to the authorised servicing centre or point of sale where you purchased the product, namely within the shortest time possible of discovering the malfunction and prior to expiry of the warranty period. When enforcing a warranty claim, you should provide the faulty device, confirmed warranty certificate and original receipt, clearly indicating name and address of the seller, date and place of purchase and type and serial number of the device.



WARRANTY CERTIFICATE

Product: KOLIBRI 360 PROFESSIONAL WIRELESS SOUND SYSTEM

Model/Package:

Kolibri serial number:

Sennheiser serial number:

Receiver frequency:

Date and place of sale:

Date of delivery:

Authorised seller:

Seller's signature and stamp:

Extended warranty:

Send the damaged product to: KOBRA Team, d. o. o.,
Levičnikova c. 2, 8310 Šentjernej, together with filled out warranty certificate and receipt.

MANUFACTURER, SELLER AND AUTHORISED SERVICE CENTRE:

KOBRA

KOBRA Team, d. o. o.

Levičnikova cesta 2

8310 Šentjernej

Slovenia

T: +386 7 30 81 118

M: + 386 41 600 700

E-mail: info@kobra.si

Websites: www.kolibrisound.si;

www.kobra.si

KOBRA

KOBRA Team, d. o. o.

Levičnikova cesta 2
8310 Šentjernej
Slovenia

T: +386 7 30 81 118
M: + 386 41 600 700
E-mail: info@kobra.si

Websites: www.kolibrisound.si; www.kobra.si